

Use and Care of the ICES model C5



Bob Dennis
Micro-Pulse LLC



Keep in mind

All Micro-Pulse ICES products are:

- NOT FDA APPROVED for any human medical condition
- Sold as research instruments, without medical claims of any kind
- Intended for RESPONSIBLE ADULT USE, for SELF-EXPERIMENT ONLY

Also:

- You should READ the C5 User Manual for details of operation
- This information is also relevant for the model B5, but for anyone who is not an active researcher we recommend the C5 rather than the B5



POWER: Use 5 Volt USB ONLY!

Power cable MUST be USB-A on one end

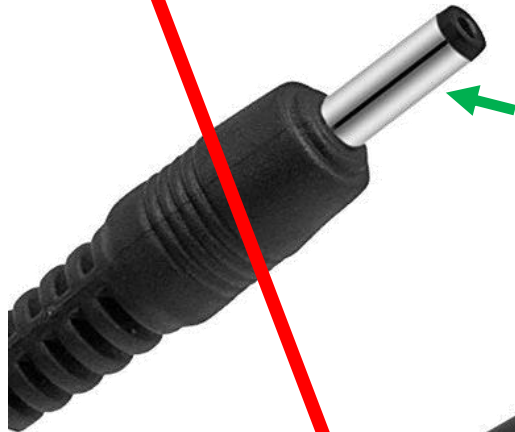

3.5 mm barrel jack goes to the C5



Use any USB charger port: 2.1 Amp or greater



USB Car charger ports:



ALL USB charger ports deliver 5.0 Volts.



COIL CARE

Getting the most out of Micro-Pulse Technology

- **ALWAYS** check your coil function with the hexagonal coil tester
- **Do not pull on or yank or sharply or bend the coil cables**
- **Make sure the coils are always firmly plugged in**
- **Test the coils before every use (listen for clicks)**
- **Replace coils when they become defective**



Flashing RED LED:

The Red LED will flash if you are doing something wrong.
This is the C5 (or B5) preventing you from overheating the device.
To prevent damage and to get the most out of your C5:



- Always keep all coils firmly and fully plugged in (you can use fewer than 4 coils)
- Check coils often, listen for clicks, and use the hexagonal coil tester
- Don't run on full power and maximum frequency for long periods
- Do not cover the C5 with blankets or pillows
(you can cover the coils, but not the device itself)



C5 - ADVANCED SYSTEM DIGNOSTICS

- Once the C5 is in RUN mode, the buttons can no longer be used to change the protocol settings.
- This is to assure that settings do not inadvertently change while the system is operating.
- While operating, the green LED will flash or toggle ON/OFF for every pulse.
- The user interface buttons have different functions when the C5 is RUNNING.
- The initial RUN screen looks like this if you happen to have selected the A9 protocol at intensity level = 9:



ADVANCED SYSTEM DIAGNOSTICS

DO NOT WORRY ABOUT THESE SCREENS UNLESS THERE HAS BEEN A MAJOR MALFUNCTION. Call Micro-Pulse for troubleshooting

Ch1	242/222V	91F
Ch2	241/220V	89F
Ch3	244/223V	90F
Ch4	242/223V	88F

**PRESS
and
HOLD**

- Once RUNNING, you can press the YELLOW (UP) button to view the internal voltages and temperatures as shown to the left.
- You may have to PRESS and HOLD the YELLOW button for one second or longer for this screen to come up.
- The voltage and temperature for each of the four channels is shown on each line.
- This is only a snapshot. The numbers do not update continuously. You must press the YELLOW button again to see the numbers update.
- Temperature is in degrees Fahrenheit, accurate only to +/- 4 F



ADVANCED SYSTEM DIAGNOSTICS

DO NOT WORRY ABOUT THESE SCREENS UNLESS THERE HAS BEEN A MAJOR MALFUNCTION. Call Micro-Pulse for troubleshooting

Channel 1 OK
Channel 2 Short
Channel 3 No Coil
Channel 4 over temp



- Once RUNNING, press the BLUE (DOWN) button to view the status of the coils. Four possible status indicators are shown: “OK” “Short” “No Coil” “Over Temp”
- You may have to PRESS and HOLD the BLUE button for one second or longer for this screen to come up.
- Here are the possible indications:
 - **OK** - this is what you should see most of the time. It means everything is OK.
 - **Short** - this usually means your coil is not pushed in far enough. Push it in.
 - **No Coil** - this usually means you do not have a coil plugged in, or a wire is broken.
 - **Over Temp** – This means the system thinks the internal temperature is getting too high
 - If the temperature is persistently too high, the C5 will warn you with a new screen, then it will flash the RED LED. Eventually the system will shut down the output power in an attempt to prevent damage. If you see this, try reducing the frequency or intensity.



ADVANCED SYSTEM DIAGNOSTICS

Channel 1 over temp
Channel 2 over temp
Channel 3 over temp
Channel 4 over temp

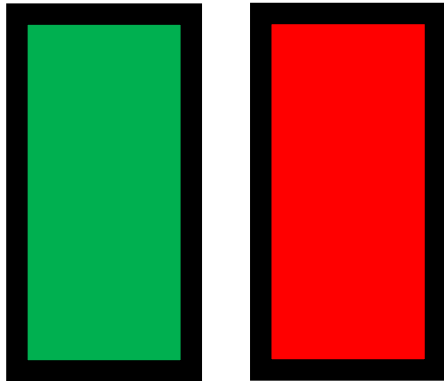

WHAT TO DO IF THE **RED LED** COMES ON

- If the red LED flashes very briefly, less than one second, that just means the system is changing modes within a protocol. This is nothing to worry about.
- If the red LED comes on for a second or two, that means the system has detected a potential OVER TEMPERATURE condition. It may correct itself, or you may need to reduce the frequency or intensity of your protocol.
- If the red LED comes on and stays on, that means a CRITICAL OVER TEMPERATURE condition has been detected. Your system is definitely running too hot and it has decided to shut down. You may see a warning screen. You should turn the power OFF. Check the coils: be sure they are plugged in all the way. A slightly pulled out coil may cause a short.
- The system may automatically adjust your intensity (power level) down to a safe level, usually level 9.



ADVANCED SYSTEM DIAGNOSTICS: Over Temp

Channel 1 over temp
Channel 2 over temp
Channel 3 over temp
Channel 4 over temp

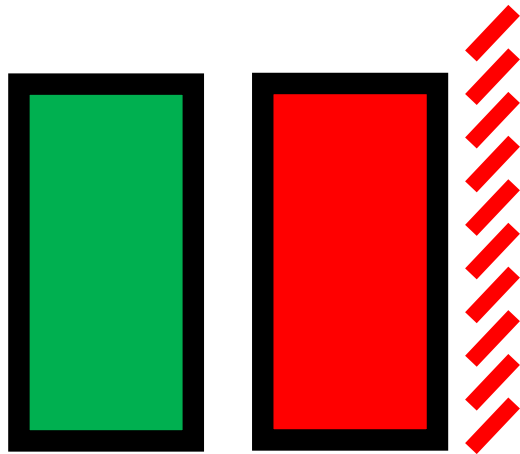

“WHY CAN’T I JUST RUN THE C5 AT FULL SPEED AND FULL POWER WITH MAXIMAL LOAD ALL THE TIME?”

- Many very good products require common sense and self control, for example: a car, a stove, etc.
- The C5 is a scientific instrument. It has not been “child-proofed”. It tries to keep you safe and prevent you from destroying it, but remember that you purchased the C5 [under the condition that you were to act like a responsible adult](#). Avoid the temptation to think that more power = more effectiveness.
- There is no scientific or rational basis to think that MORE POWER makes PEMF work better. When properly designed, PEMF works best at very low power.
- If the C5 tells you it is in the danger zone, then it is too much. Tone it down a bit by reducing the power level.



POWER: Use 5 Volt USB ONLY!

Power cable MUST be USB-A on one end

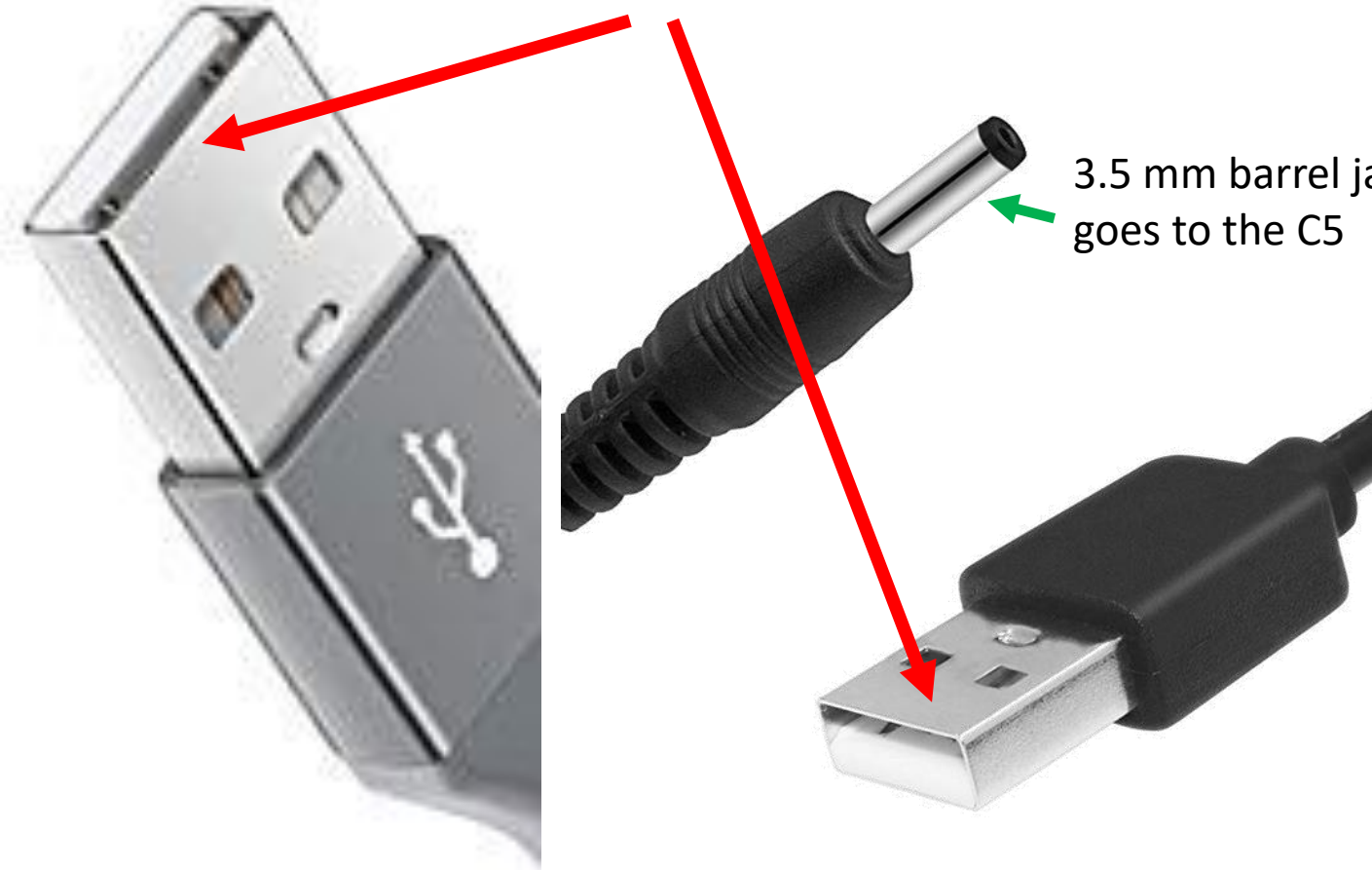

3.5 mm barrel jack goes to the C5

Use any USB charger port: 2.1 Amp or greater



USB Car charger ports:



ALL USB charger ports deliver 5.0 Volts.



COIL CARE

Getting the most out of Micro-Pulse Technology

- **ALWAYS** check your coil function with the hexagonal coil tester
- **Do not pull on or yank or sharply or bend the coil cables**
- **Make sure the coils are always firmly plugged in**
- **Test the coils before every use (listen for clicks)**
- **Replace coils when they become defective**



PREVENT OVERHEATING

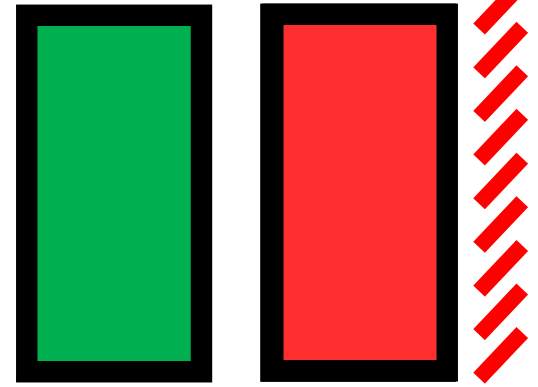

PREVENT OVERHEATING: flashing red LED = overheating

- Do not run at full power and maximum frequency
- Do not cover with pillows or blankets
- Use in a cool location with air flow
- Make sure all coils are firmly plugged in

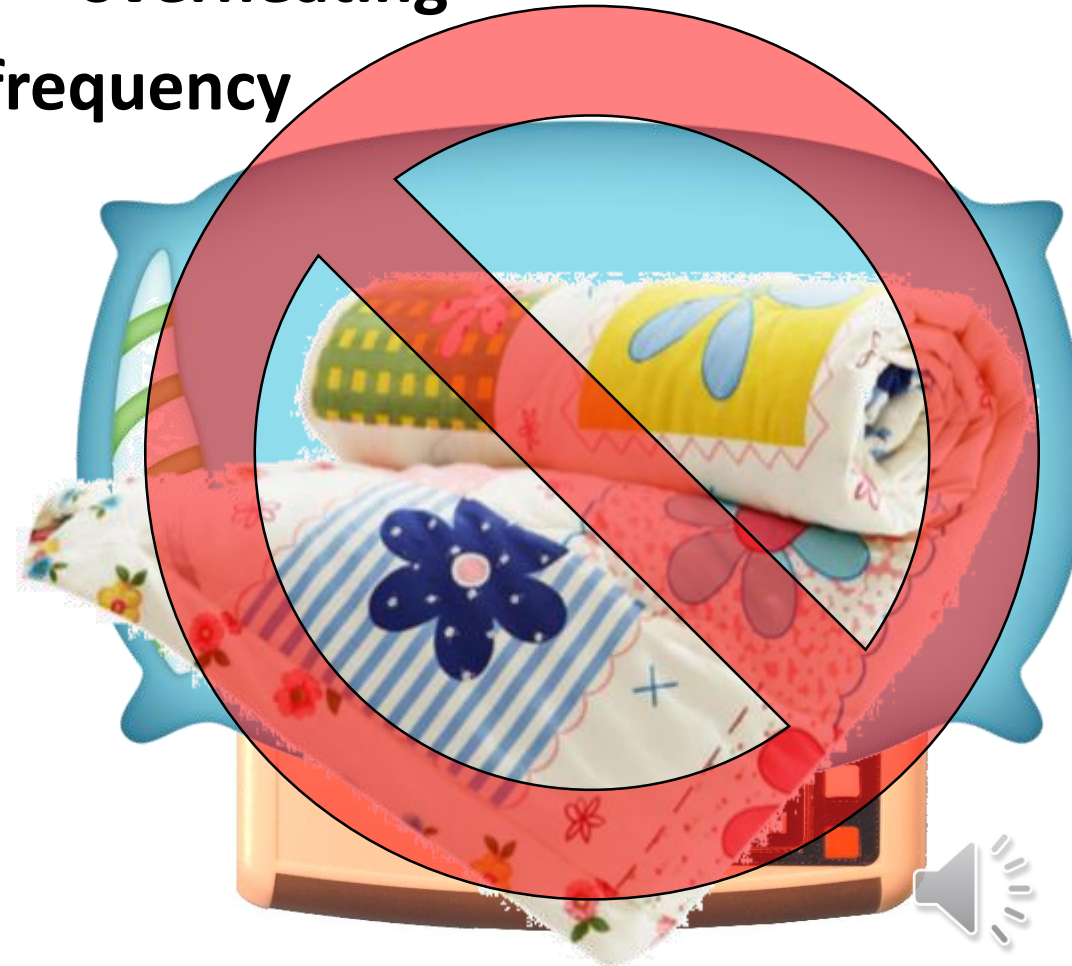

OK to place coils under pillows/blankets

Coils and coil arrays CAN be placed under pillows and blankets

- **Make sure coils are firmly plugged in**
- **Test coils frequently using hexagonal coil tester**



Micro-Pulse

Model C5

Bob Dennis

